

28.31 M / 92'89"



## CARACTÉRISTIQUES PRINCIPALES

Builder

Built Year

2016

Length

28.31 M / 92'89"

Beam

7.00 M / 22'96"

Draft

2.21 M / 7'25"

Displacement

106.09 tonnes

Registry

Indonésie

**5,300,000 EUR** 6,203,618 USD\*

\* Conversion approximative



Adresse:

3 Rue de la Loge L-1945 Luxembourg



Contact

Thomas Peltier • P: +352.27.40.99.90 • M: +352.621.326.323



E-mail:

t.peltier@seastemia.com

28.31 M / 92'89"

## SPÉCIFICATIONS

## DÉTAILS DU BATEAU

<b>Built Year</b>	2016	<b>Registry</b>	Indonésie
-------------------	------	-----------------	-----------

## CERTIFICATION

<b>Certification</b>	RINA	<b>Category</b>	A
----------------------	------	-----------------	---

**Compliance** B + R + Aa Sound Emission

## BUILDER / DESIGNER

<b>Builder</b>	
----------------	--

## DIMENSIONS

<b>Length</b>	28.31 M / 92'89"	<b>Beam</b>	7.00 M / 22'96"
---------------	------------------	-------------	-----------------

**Draft** 2.21 M / 7'25" **Displacement** 106.09 tonnes

## MACHINERY

<b>Engine Maker</b>	MAN	<b>Drive</b>	Shaft
---------------------	-----	--------------	-------



Adresse:

3 Rue de la Loge L-1945 Luxembourg



Contact

Thomas Peltier • P: +352.27.40.99.90 • M: +352.621.326.323



E-mail:

t.peltier@seastemia.com

28.31 M / 92'89"

## MACHINERY

<b>Number of Engines</b>	2	<b>Propulsion Mode</b>	Diesel
<b>Engine(s) type</b>	Inboard	<b>Engine(s) power</b>	1,200.00 hp
<b>Engine(s) model</b>	Man V8 - 1200	<b>Heures moteur 1</b>	550.00 H.
<b>Heures moteur 2</b>	550.00 H.	<b>Main Generator Maker</b>	Kohler
<b>Main Generator Power</b>	28.00 KW	<b>Main Generator Hours</b>	1,000.00 H.
<b>Auxiliary Generator Maker</b>	Kohler	<b>Auxiliary Generator Power</b>	20.00 KW
<b>Auxiliary Generator Hours</b>	1,000.00 H.	<b>Stabilizer Maker</b>	Stabilizer fins underway and zero speed
<b>Water Maker</b>	250 ltrs x 2 Duplex IDROMAR	<b>Water Maker Flow</b>	500.00 l/H / 132.00 gal/H
<b>AC type</b>	Tropical (Salon + Cabins + 3 Crew)		

## PERFORMANCES

<b>Cruising Speed</b>	11.00 noeuds	<b>Max Speed</b>	15.00 noeuds
-----------------------	--------------	------------------	--------------

## TANKAGES

<b>Fuel</b>	12,500.00 litres / 3,300.00 US gals	<b>Water</b>	2,000.00 litres / 528.00 US gals
-------------	-------------------------------------	--------------	----------------------------------



Adresse:

3 Rue de la Loge L-1945 Luxembourg



Contact

Thomas Peltier • P: +352.27.40.99.90 • M: +352.621.326.323



E-mail:

t.peltier@seastemia.com

28.31 M / 92'89"

### TANKAGES

**Grey Water**

700.00 litres / 184.80 US gals

**Black Water**

700.00 litres / 184.80 US gals

### ACCOMODATIONS

**Sleeps**

10 guests

**Couquette**

2 simple, 4 double

**Bathroom**

6

**Crew**

5

**Crew Berths**

5



Adresse:

3 Rue de la Loge L-1945 Luxembourg



Contact

Thomas Peltier • P: +352.27.40.99.90 • M: +352.621.326.323



E-mail:

t.peltier@seastemia.com



28.31 M / 92'89"







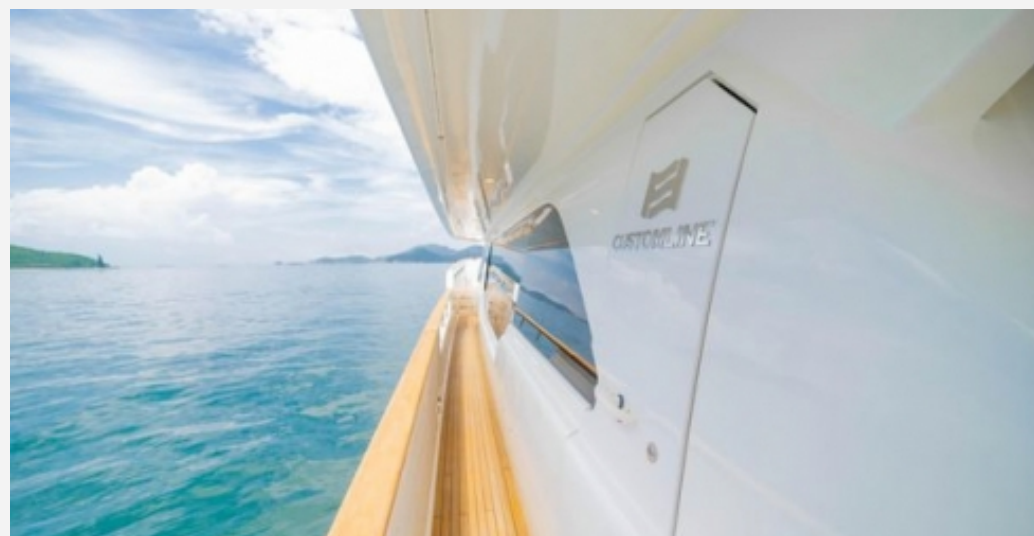
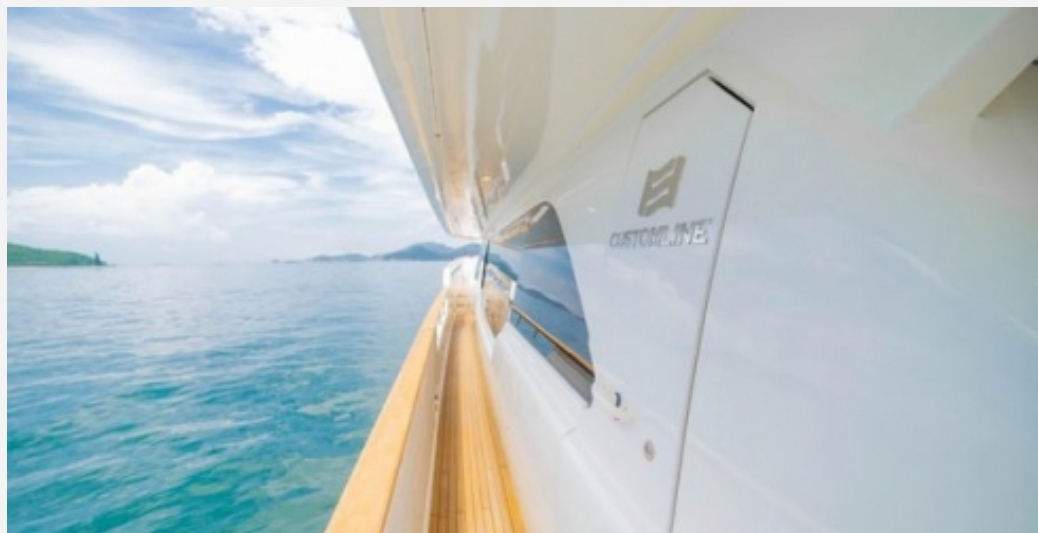



28.31 M / 92'89"











































28.31 M / 92'89"





28.31 M / 92'89"



28.31 M / 92'89"

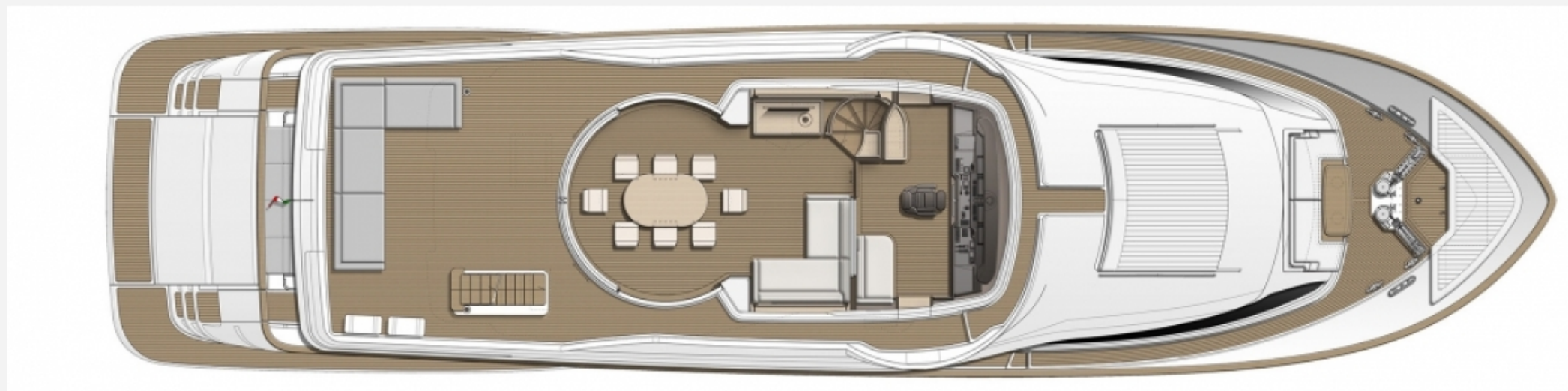



28.31 M / 92'89"

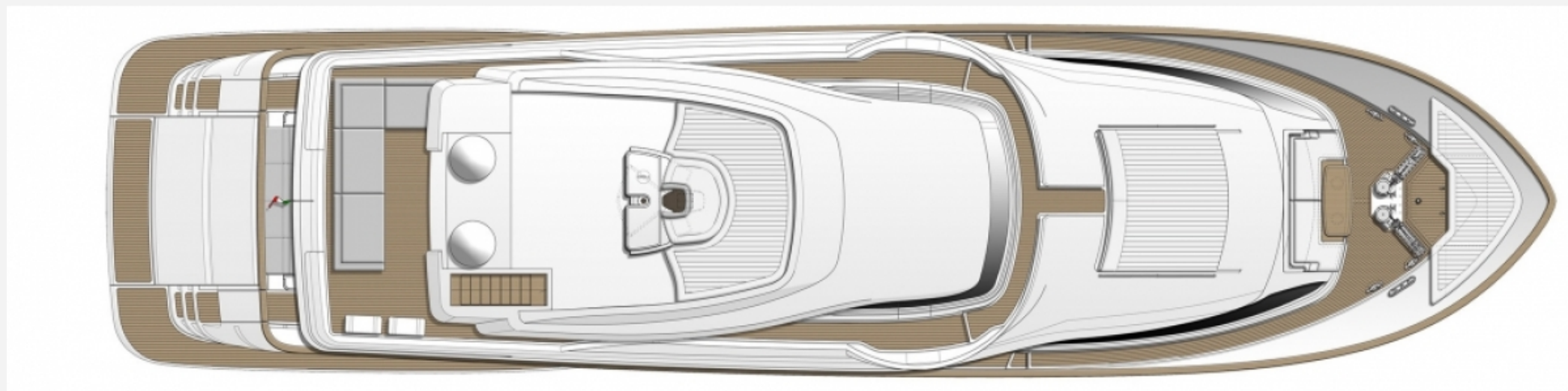

28.31 M / 92'89"





28.31 M / 92'89"

