

28.31 M / 92'89"



CARACTÉRISTIQUES PRINCIPALES

Builder**Built Year**

2016

Length

28.31 M / 92'89"

Beam

7.00 M / 22'96"

Draft

2.21 M / 7'25"

Displacement

106.09 tonnes

Registry

Indonésie

4,100,000 EUR 4,678,334 USD*

* Conversion approximative

 Adresse:

3 Rue de la Loge L-1945 Luxembourg

 Contact

Thomas Peltier • P: +352.27.40.99.90 • M: +352.621.326.323

 E-mail:

t.peltier@seastemia.com

28.31 M / 92'89"

SPÉCIFICATIONS

DÉTAILS DU BATEAU

Built Year	2016	Registry	Indonésie
-------------------	------	-----------------	-----------

CERTIFICATION

Certification	RINA	Category	A
Compliance	B + R + Aa Sound Emission		

BUILDER / DESIGNER

Builder

DIMENSIONS

Length	28.31 M / 92'89"	Beam	7.00 M / 22'96"
Draft	2.21 M / 7'25"	Displacement	106.09 tonnes

MACHINERY

Engine Maker	MAN	Drive	Shaft
---------------------	-----	--------------	-------

28.31 M / 92'89"

MACHINERY

Number of Engines	2	Propulsion Mode	Diesel
Engine(s) type	Inboard	Engine(s) power	1,200.00 hp
Engine(s) model	Man V8 - 1200	Heures moteur 1	550.00 H.
Heures moteur 2	550.00 H.	Main Generator Maker	Kohler
Main Generator Power	28.00 KW	Main Generator Hours	1,000.00 H.
Auxiliary Generator Maker	Kohler	Auxiliary Generator Power	20.00 KW
Auxiliary Generator Hours	1,000.00 H.	Stabilizer Maker	Stabilizer fins underway and zero speed
Water Maker	250 ltrs x 2 Duplex IDROMAR	Water Maker Flow	500.00 l/H / 132.00 gal/H
AC type	Tropical (Salon + Cabins + 3 Crew)		

PERFORMANCES

Cruising Speed	11.00 noeuds	Max Speed	15.00 noeuds
-----------------------	--------------	------------------	--------------

TANKAGES

Fuel	12,500.00 litres / 3,300.00 US gals	Water	2,000.00 litres / 528.00 US gals
-------------	-------------------------------------	--------------	----------------------------------

28.31 M / 92'89"

TANKAGES

Grey Water

700.00 litres / 184.80 US gals

Black Water

700.00 litres / 184.80 US gals

ACCOMODATIONS

Sleeps

10 guests

Courette

2 simple, 4 double

Bathroom

6

Crew

5

5

28.31 M / 92'89"



28.31 M / 92'89"



28.31 M / 92'89"



28.31 M / 92'89"



28.31 M / 92'89"



28.31 M / 92'89"



28.31 M / 92'89"



28.31 M / 92'89"



28.31 M / 92'89"



28.31 M / 92'89"



28.31 M / 92'89"



28.31 M / 92'89"



28.31 M / 92'89"



28.31 M / 92'89"



28.31 M / 92'89"



28.31 M / 92'89"



28.31 M / 92'89"



28.31 M / 92'89"

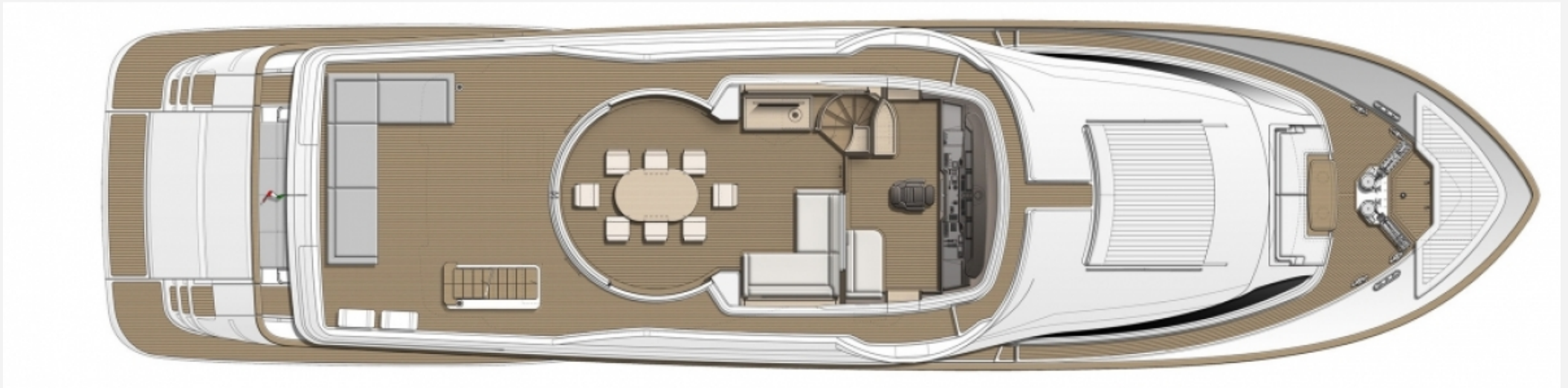

28.31 M / 92'89"

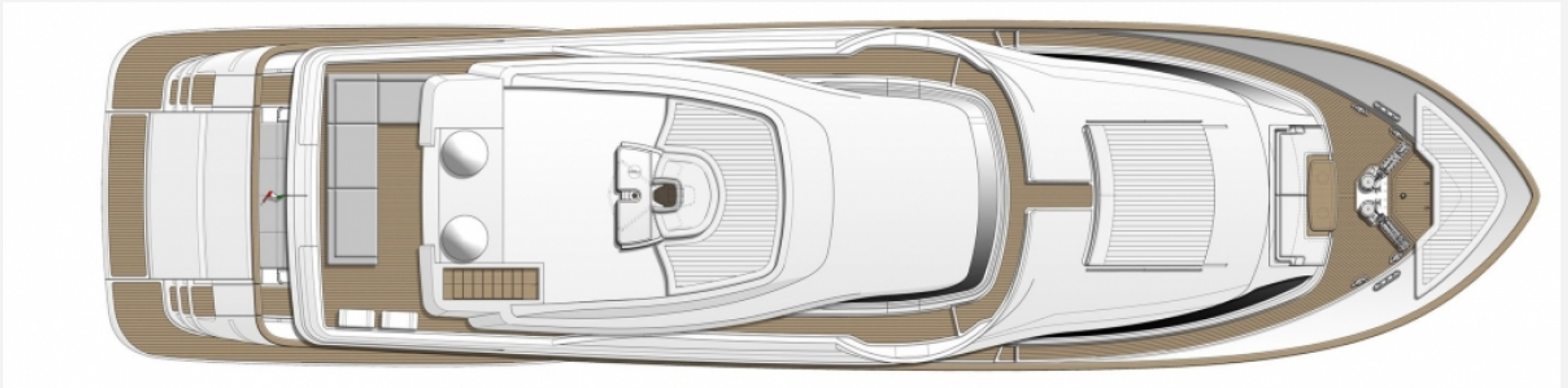

28.31 M / 92'89"



28.31 M / 92'89"

