

19.03 M / 62'43"



CARACTÉRISTIQUES PRINCIPALES

Length	19.03 M / 62'43"
Beam	4.75 M / 15'58"
Draft	1.70 M / 5'58"
Displacement	25.92 tonnes

POA

* Conversion approximative

🏠 Adresse:

3 Rue de la Loge L-1945 Luxembourg

📞 Contact

Thomas Peltier • P: +352.27.40.99.90 • M: +352.621.326.323

✉ E-mail:

t.peltier@seastemia.com

19.03 M / 62'43"

SPÉCIFICATIONS

DÉTAILS DU BATEAU

Main Category	Motor yacht	Boat Status	New
----------------------	-------------	--------------------	-----

DIMENSIONS

Length	19.03 M / 62'43"	Beam	4.75 M / 15'58"
Draft	1.70 M / 5'58"	Displacement	25.92 tonnes
Ballast Weight	25.92 tonnes		

MACHINERY

Engine Maker	MAN	Drive	Shaft
Number of Engines	2	Propulsion Mode	Diesel
Engine(s) type	Inboard	Engine(s) power	1,400.00 hp

PERFORMANCES

Cruising Speed	37.00 noeuds	Max Speed	40.00 noeuds
-----------------------	--------------	------------------	--------------

19.03 M / 62'43"

PERFORMANCES

Range 255.00 NM

TANKAGES

Fuel 3,250.00 litres / 858.00 US gals

Water 700.00 litres / 184.80 US gals

19.03 M / 62'43"



19.03 M / 62'43"



19.03 M / 62'43"



19.03 M / 62'43"



19.03 M / 62'43"



19.03 M / 62'43"



19.03 M / 62'43"



19.03 M / 62'43"

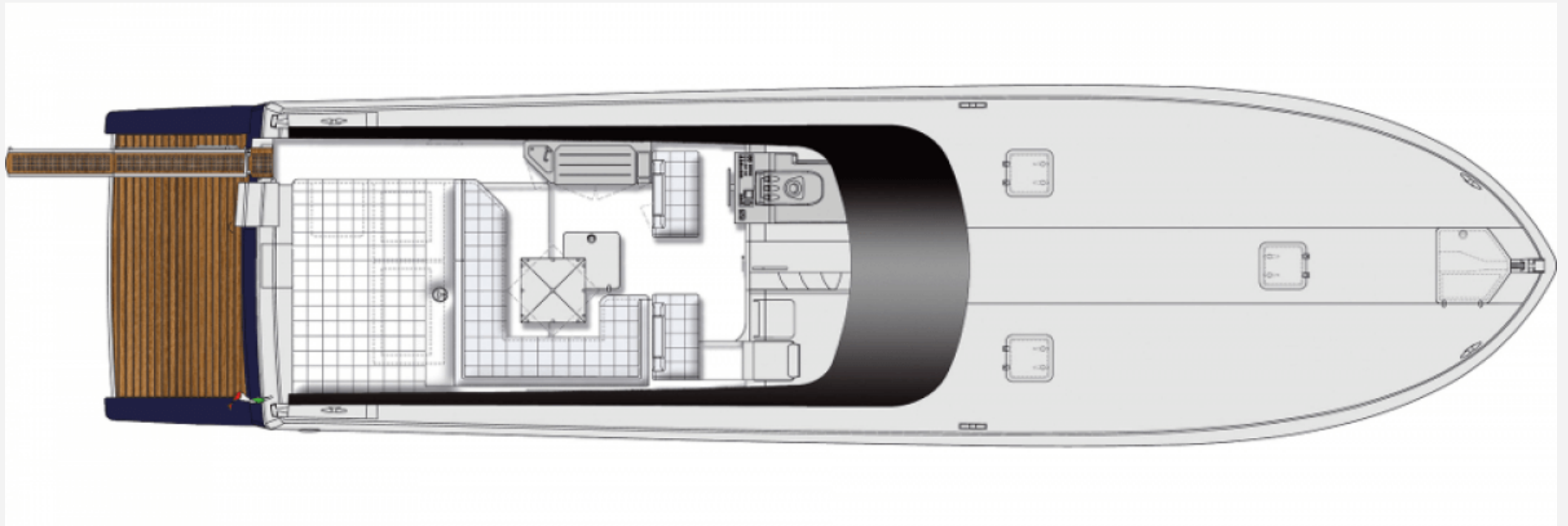

19.03 M / 62'43"

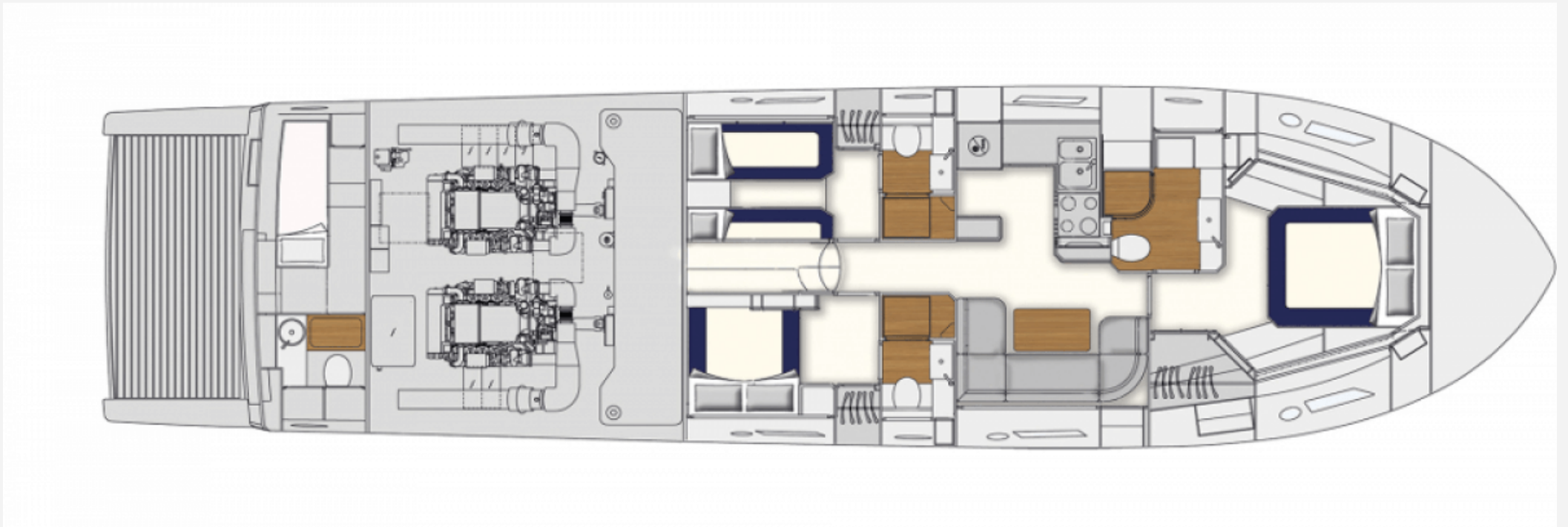

19.03 M / 62'43"

