

19.63 M / 64'40"



## CARACTÉRISTIQUES PRINCIPALES

**Builder****Length**

19.63 M / 64'40"

**Beam**

6.23 M / 20'44"

**Draft**

1.79 M / 5'87"

**Displacement**

45.40 tonnes

# POA

\* Conversion approximative

🏠 Adresse:

3 Rue de la Loge L-1945 Luxembourg

📞 Contact

Thomas Peltier • P: +352.27.40.99.90 • M: +352.621.326.323

✉ E-mail:

t.peltier@seastemia.com

19.63 M / 64'40"

## SPÉCIFICATIONS

## CERTIFICATION

<b>Certification</b>	RINA	<b>Category</b>	A
<b>Compliance</b>	B + F + Aa (Sound Emission)		

## BUILDER / DESIGNER

**Builder**

## DIMENSIONS

<b>Length</b>	19.63 M / 64'40"	<b>Beam</b>	6.23 M / 20'44"
<b>Draft</b>	1.79 M / 5'87"	<b>Displacement</b>	45.40 tonnes

## MACHINERY

<b>Engine Maker</b>	MTU	<b>Drive</b>	Shaft
<b>Number of Engines</b>	2	<b>Propulsion Mode</b>	Diesel
<b>Engine(s) type</b>	Inboard	<b>Engine(s) power</b>	1,268.00 hp

19.63 M / 64'40"

## MACHINERY

**Engine(s) model** MTU 8V 2000 M94

## PERFORMANCES

**Cruising Speed** 27.00 noeuds**Max Speed** 31.00 noeuds**Range** 250.00 NM**Cruising Speed for Range** 27.00 noeuds

## TANKAGES

**Fuel** 3,600.00 litres / 950.40 US gals**Water** 990.00 litres / 261.36 US gals

## ACCOMODATIONS

**Sleeps** 6 guests**Courette** 2 simple, 2 double**Bathroom** 3**Crew** 1**Crew Berths** 1



19.63 M / 64'40"





19.63 M / 64'40"





19.63 M / 64'40"





19.63 M / 64'40"



19.63 M / 64'40"





19.63 M / 64'40"



19.63 M / 64'40"





19.63 M / 64'40"

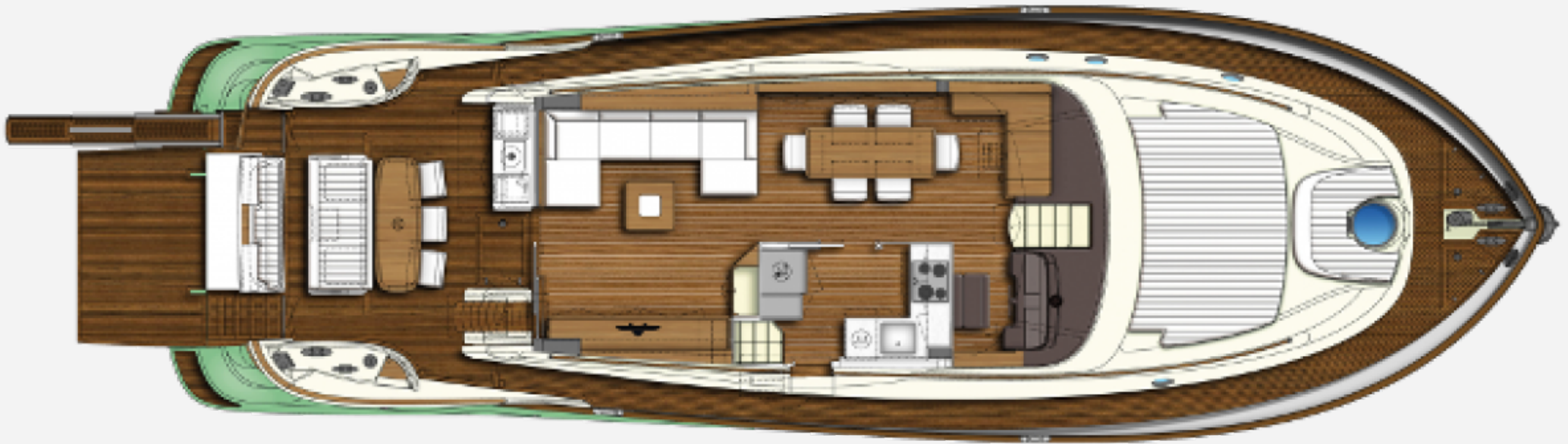

19.63 M / 64'40"

