

23.99 M / 78'70"



CARACTÉRISTIQUES PRINCIPALES

Length	23.99 M / 78'70"
Beam	6.78 M / 22'25"
Draft	2.00 M / 6'55"
Displacement	85.00 tonnes

POA

* Conversion approximative

🏠 Adresse:

3 Rue de la Loge L-1945 Luxembourg

📞 Contact

Thomas Peltier • P: +352.27.40.99.90 • M: +352.621.326.323

✉ E-mail:

t.peltier@seastemia.com

SPÉCIFICATIONS

CERTIFICATION

Certification	RINA	Category	A
Compliance	B + F + A1 (SOUND EMISSION) RINA S.P.A.		

DIMENSIONS

Length	23.99 M / 78'70"	Beam	6.78 M / 22'25"
Draft	2.00 M / 6'55"	Displacement	85.00 tonnes

MACHINERY

Engine Maker	Volvo	Drive	Pod Drive
Number of Engines	3	Propulsion Mode	Diesel
Engine(s) power	1,000.00 hp	Engine(s) model	VOLVO PENTA D13 IPS1350 (Opt)

PERFORMANCES

Cruising Speed	20.00 noeuds	Max Speed	23.00 noeuds
-----------------------	--------------	------------------	--------------

PERFORMANCES

Cruising Speed for Range 370.00 noeuds

TANKAGES

Fuel 9,000.00 litres / 2,376.00 US gals

Water 2,000.00 litres / 528.00 US gals

ACCOMODATIONS

Sleeps 8 guests

Courette 2 simple, 3 double

Bathroom 4

Crew 2

Crew Berths 2

23.99 M / 78'70"

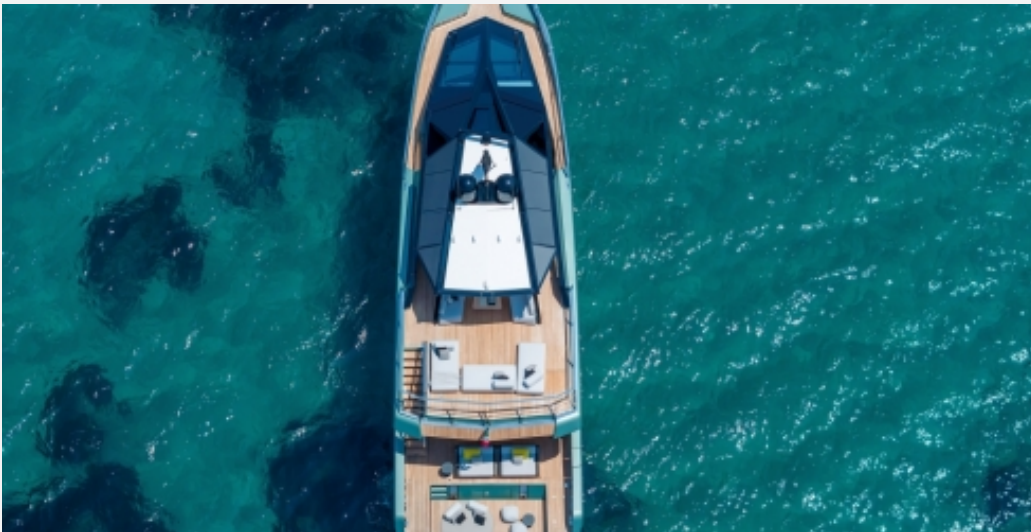

23.99 M / 78'70"



23.99 M / 78'70"

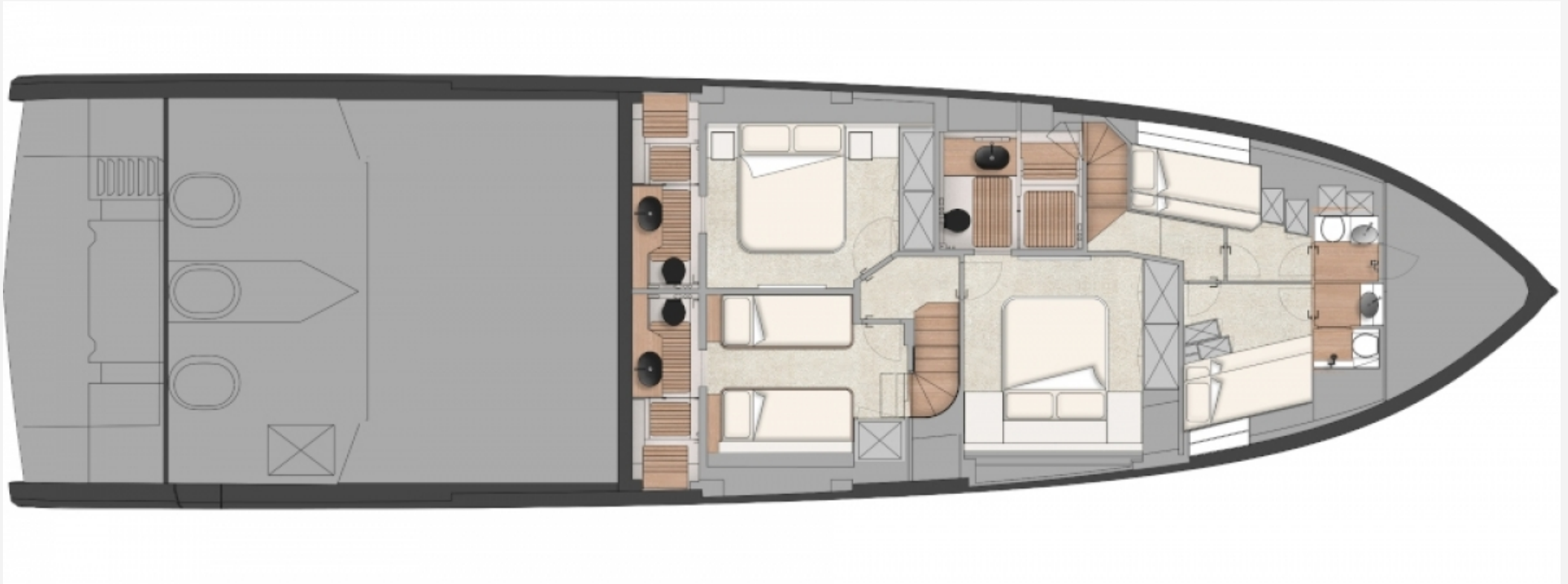

23.99 M / 78'70"



23.99 M / 78'70"

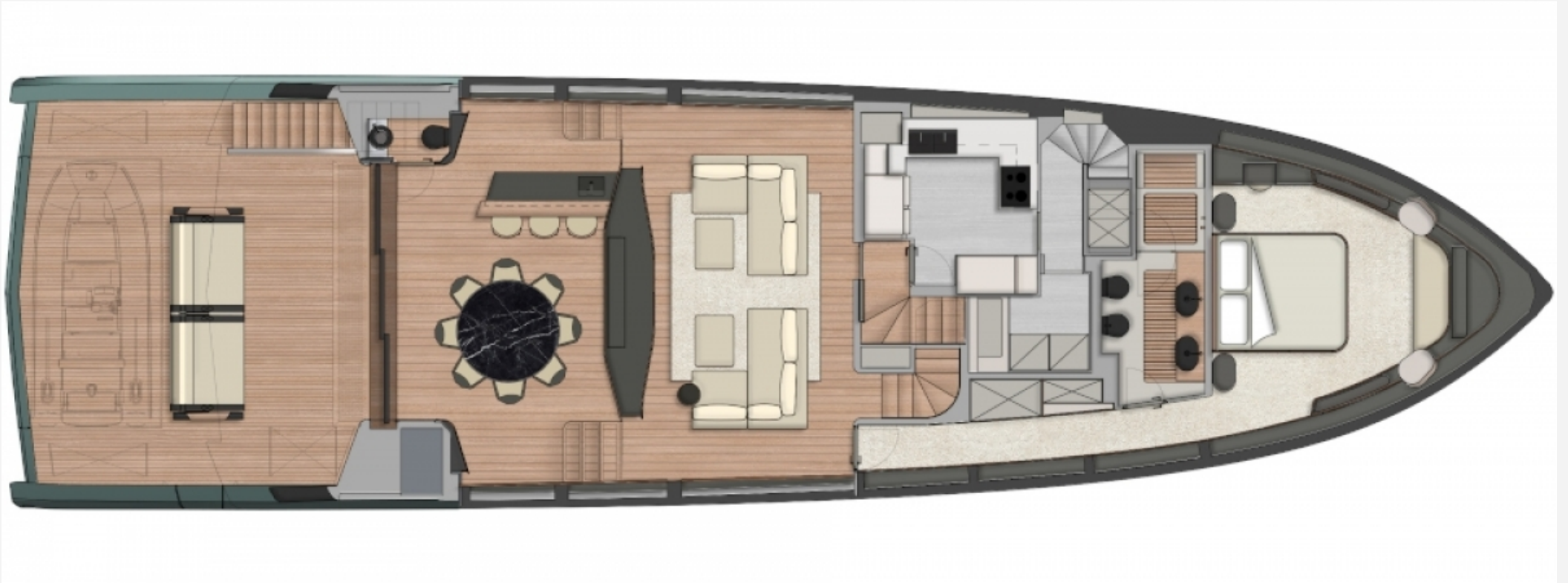

23.99 M / 78'70"



23.99 M / 78'70"

