

38.76 M / 127'17"



CARACTÉRISTIQUES PRINCIPALES

Builder**Length**

38.76 M / 127'17"

Beam

8.00 M / 26'25"

Draft

2.27 M / 7'45"

Displacement

202.00 tonnes

POA

* Conversion approximative

🏠 Adresse:

3 Rue de la Loge L-1945 Luxembourg

📞 Contact

Thomas Peltier • P: +352.27.40.99.90 • M: +352.621.326.323

✉ E-mail:

t.peltier@seastemia.com

38.76 M / 127'17"

SPÉCIFICATIONS

CERTIFICATION

Certification	RINA	Compliance	Commercial MCA Compliant
----------------------	------	-------------------	--------------------------

BUILDER / DESIGNER

Builder		Model	Navetta 38
----------------	--	--------------	------------

DIMENSIONS

Length	38.76 M / 127'17"	Beam	8.00 M / 26'25"
Draft	2.27 M / 7'45"	Displacement	202.00 tonnes

MACHINERY

Engine Maker	Caterpillar	Drive	Shaft
Number of Engines	2	Propulsion Mode	Diesel
Engine(s) power	1,622.00 hp	Engine(s) model	CAT ACERT32V12 EPA Tier3
Gearboxes/Transmission	2x ZF 3350	Main Generator Maker	ZENORO

38.76 M / 127'17"

MACHINERY

Main Generator Power	80.00 KW	Auxiliary Generator Maker	ZENORO
Auxiliary Generator Power	80.00 KW	Stabilizer Type	Hydraulic Thins
Stabilizer Maker	NAIAD DYNANICS unndrway and zero speed	Water Maker	Idromar Duplex (250+250) (with UV sterilizer for drinkable water)
Water Maker Flow	500.00 l/H / 132.00 gal/H	AC type	Tropical with UTA System (to renewthe air)

PERFORMANCES

Cruising Speed	13.00 noeuds	Max Speed	16.00 noeuds
Range	3,000.00 NM	Cruising Speed for Range	10.00 noeuds

TANKAGES

Fuel	37,000.00 litres / 9,768.00 US gals	Water	4,000.00 litres / 1,056.00 US gals
Grey Water	1,900.00 litres / 501.60 US gals	Black Water	1,900.00 litres / 501.60 US gals

38.76 M / 127'17"



38.76 M / 127'17"



38.76 M / 127'17"



38.76 M / 127'17"



38.76 M / 127'17"



38.76 M / 127'17"



38.76 M / 127'17"



38.76 M / 127'17"



38.76 M / 127'17"



38.76 M / 127'17"



38.76 M / 127'17"

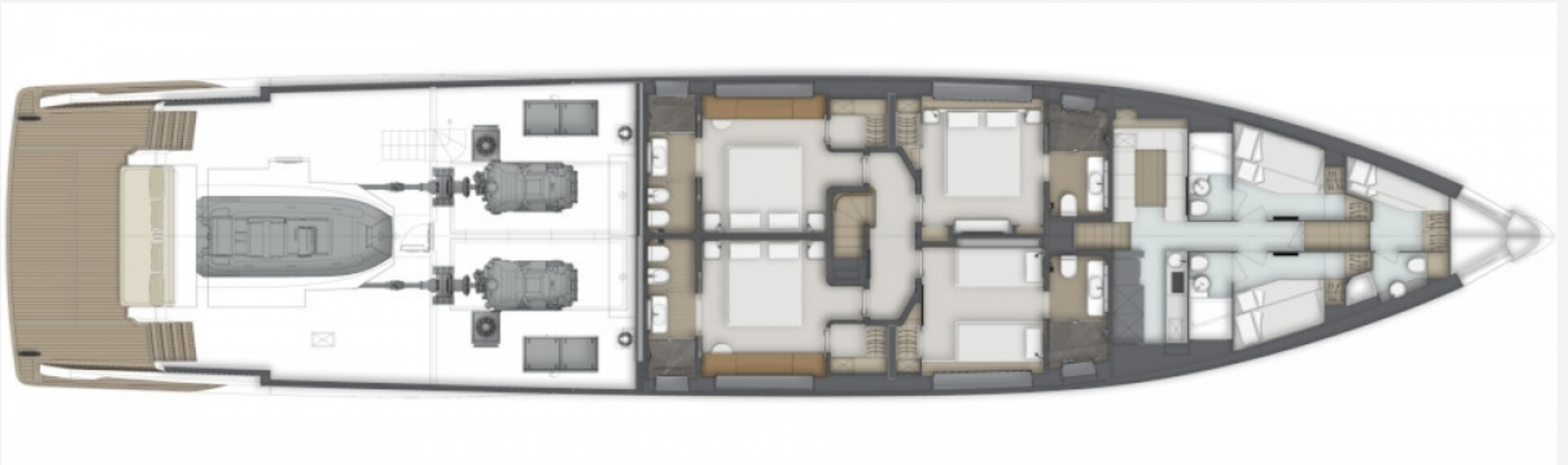

38.76 M / 127'17"

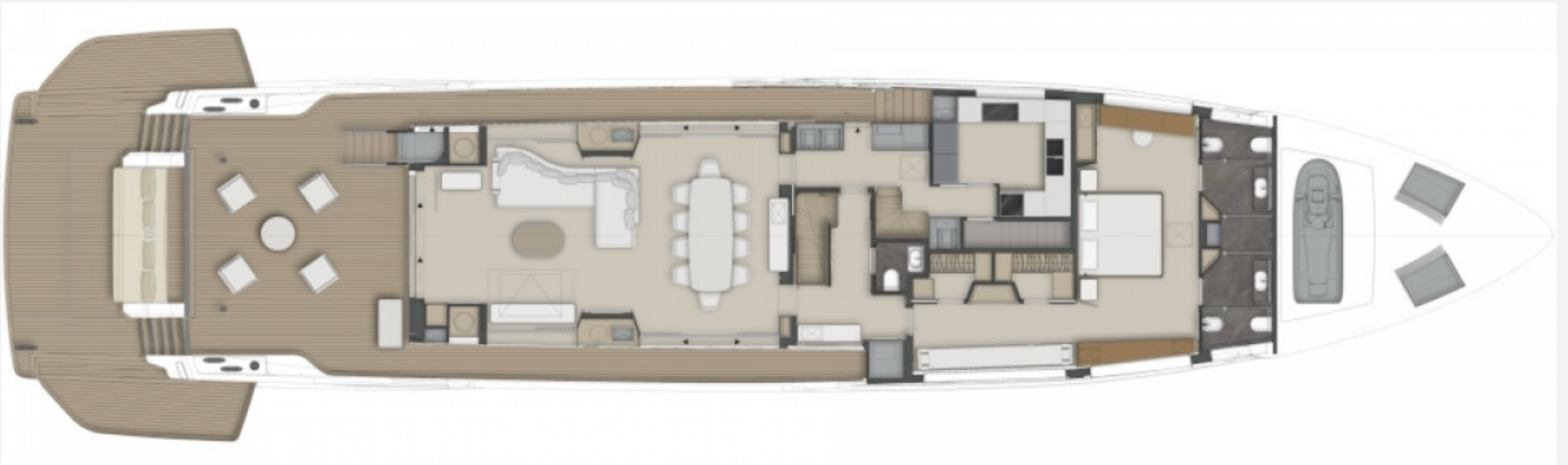

38.76 M / 127'17"

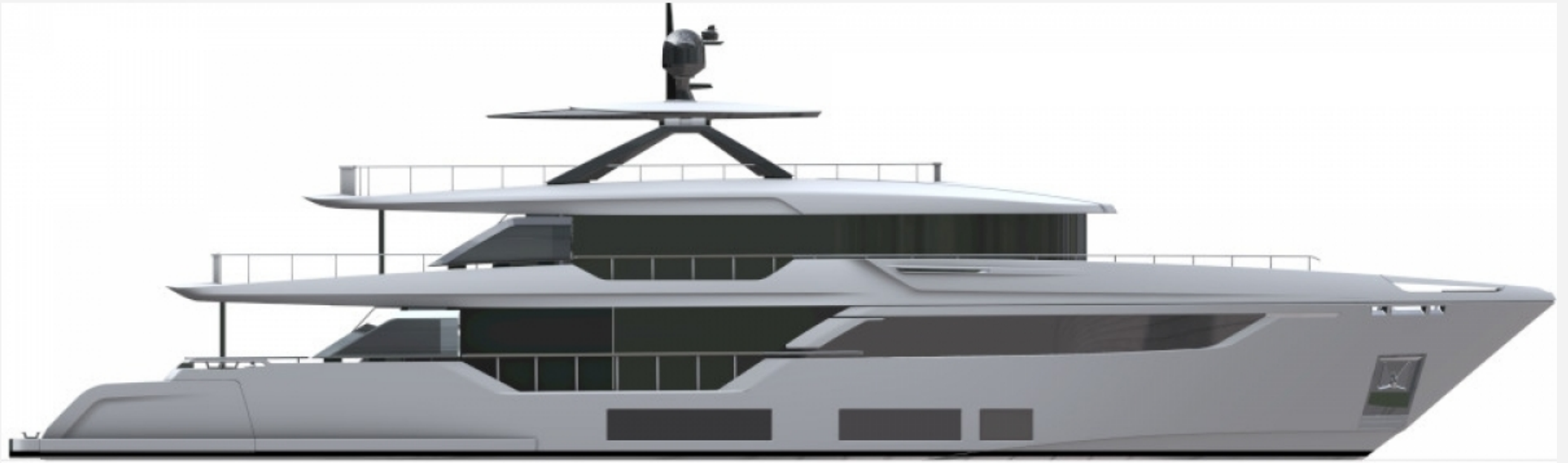

38.76 M / 127'17"



38.76 M / 127'17"

